

MORTGAGE INSPECTION

of
Lots 1 and 2 of Block Z, Delavan Lake Assembly Grounds
Subdivision, located in Section 21, T2N, R16E,
Walworth County, Wisconsin.

Prepared for: Hopkins Savings & Loan
37 E. Milwaukee Avenue
Fort Atkinson, WI. 53538

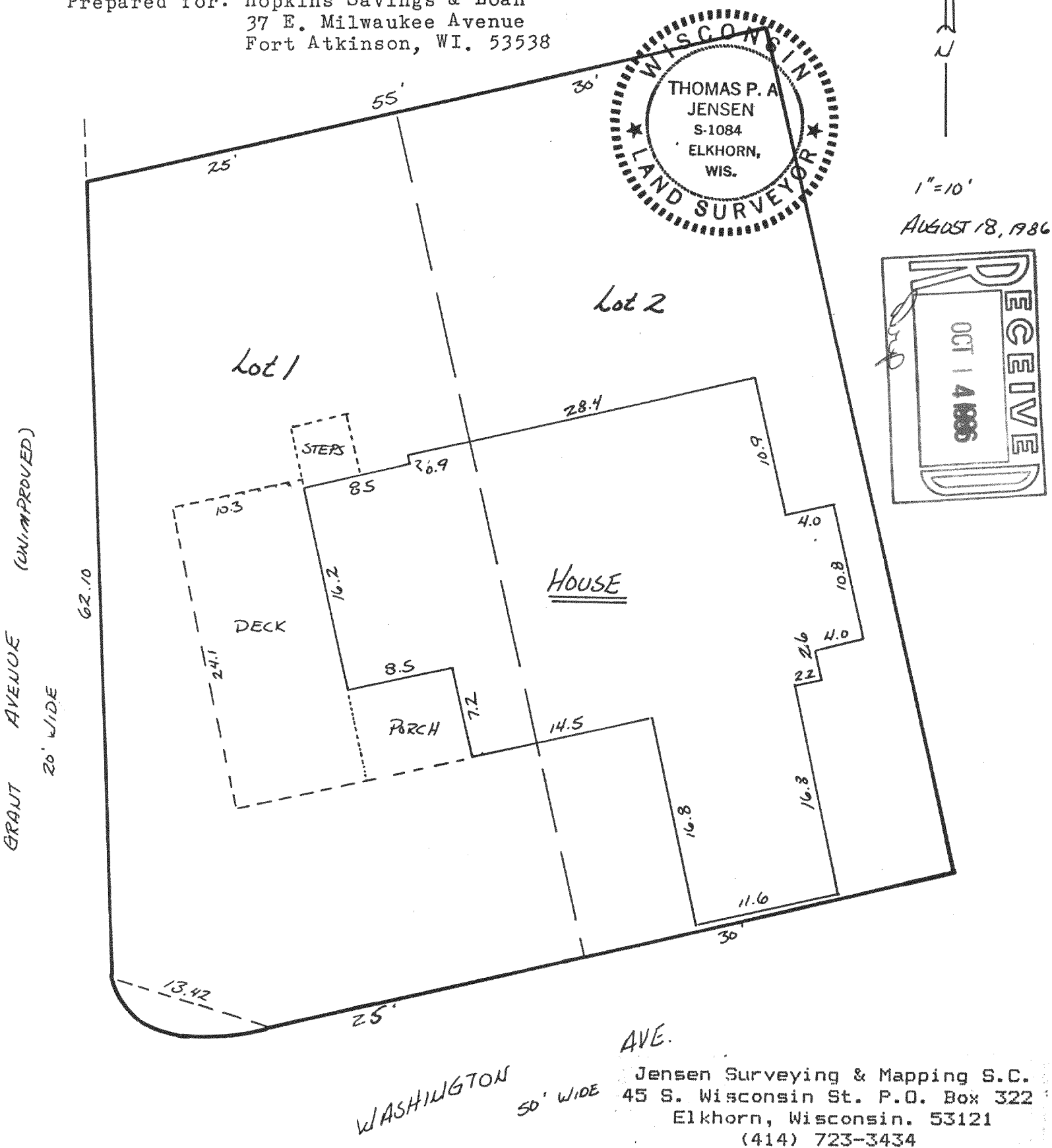

Jensen Surveying & Mapping S.C.
45 S. Wisconsin St. P.O. Box 322
Elkhorn, Wisconsin. 53121
(414) 723-3434

NOTE: In accordance with A-E 5.01 (1)(b) this inspection has been exempted in writing by Hopkins Savings & Loan from the requirements of A-E 5.01 Minimum Standards for Property Surveys. Lot dimensions are shown as recorded on the legal description or subdivision plat. These dimensions were not necessarily verified in the field and no lot stakes were set in the course of this inspection. The Legal Description is shown as previously recorded or as provided by the person ordering this inspection. This inspection does not constitute a complete property survey and cannot be relied on as such.

CERTIFICATION:

I certify that the property described hereon has been inspected under my responsible direction and supervision and that the above map is an accurate representation of the size and location of the property and the location and dimensions of all visible structural improvements, if any.

Thomas P.A. Jensen S-1084